

# Operation

Buttons and display of the wire controller.

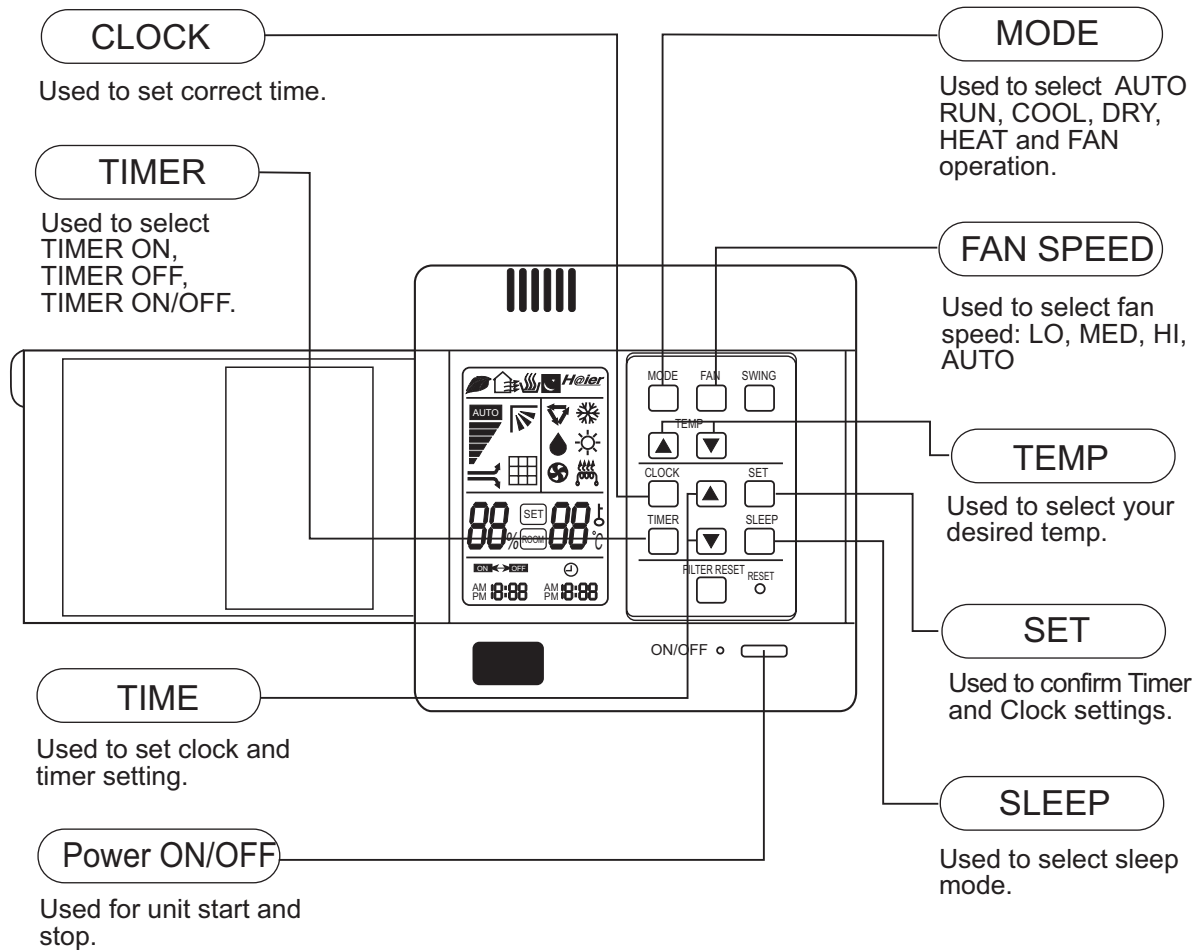

**Cautions:**  
On cooling only unit, heating mode is not available.

**Note:**  
The above information is the explanation of the displayed information therefore varies with those displayed in actual operation.

# Operation

Buttons and display of the wire controller.

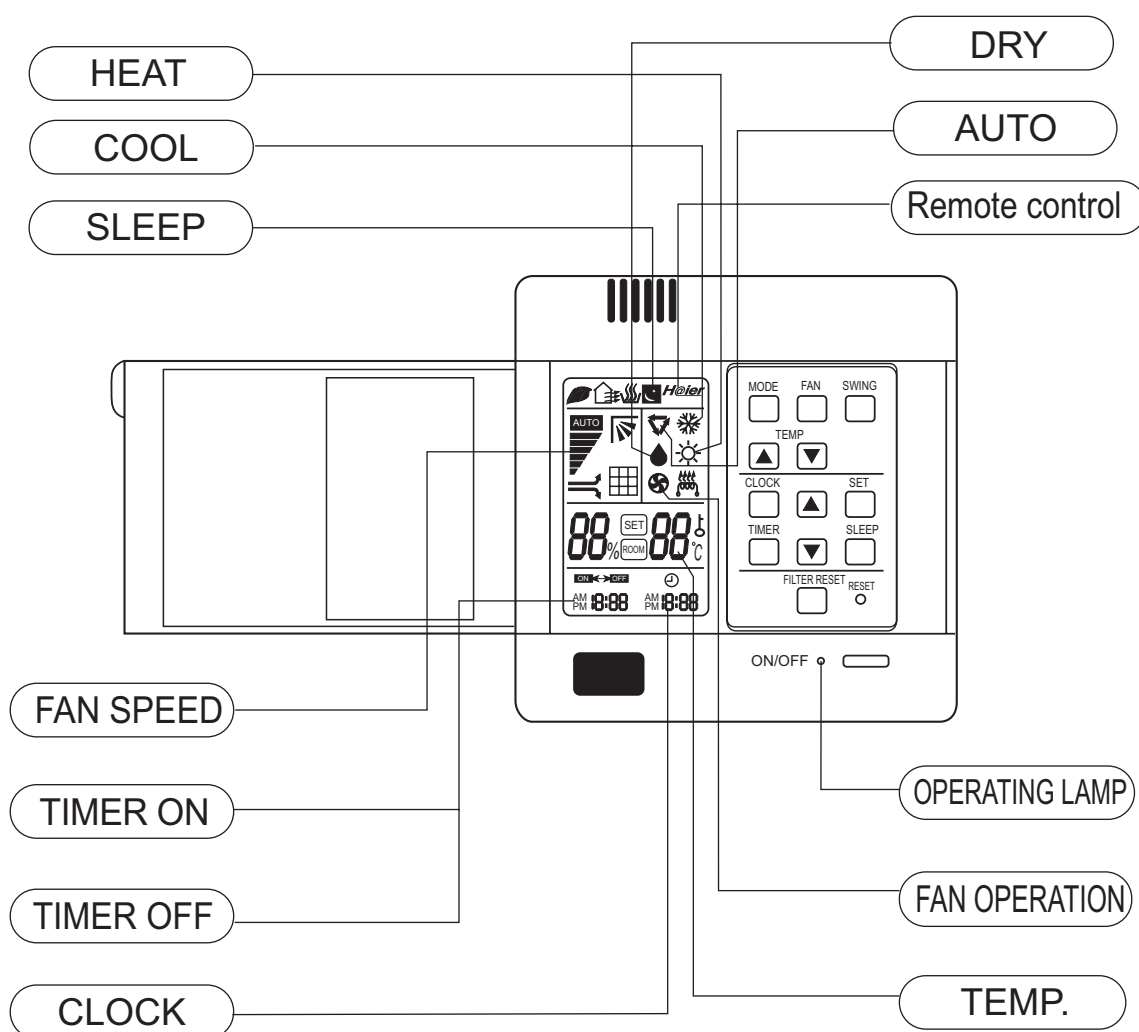

## Clock

When unit is started for the first time, clock should be adjusted as follows:

- Press **CLOCK** button, "AM" or "PM" flashes.
- Press **▲** or **▼** to set correct time. Each press will increase or decrease 1min. If the button is kept depressed, time will change quickly.
- After time setting is confirmed, press **SET**, "AM" and "PM" stop flashing, while clock starts working.

# ■ OPERATION

The air conditioner has the function of **POWER FAILURE RESUME**.

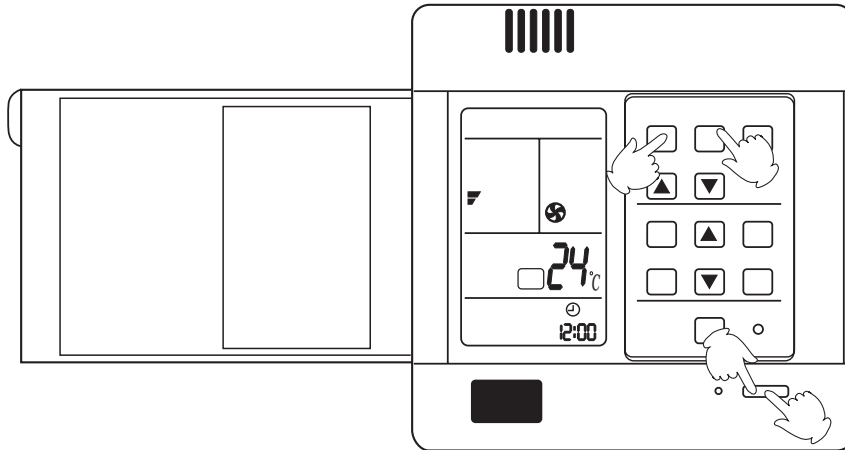

## Fan operation

Enjoy yourself by just a gentle press.

### (1) Unit start

Press ON/OFF button, unit starts.  
Previous operation status appears on display.  
(Not Timer setting)  
Power indicator lights up.

### (2) Select operation mode

Press MODE button. For each press, operation mode changes as follows:



Unit will run in selected mode.  
stop display at " FAN " FAN.

For cooling only type no " HEAT " function.

### (3) Fan

Press FAN button. For each press, fan speed changes as follows:



Unit will run at selected fan speed.

### (4) Unit stop

Press ON/OFF button.  
Only time and room temp remains on LCD.  
All indicators go out.  
Vertical flap closed automatically.

## Hints

Wire controller can memorize settings in each operation mode. To run it next time just select the operation mode and it will start with the previous setting.

No reselecting is needed.(TIMER ON/OFF needs reselecting)

In FAN mode, temp. can't be set.

# ■ OPERATION

## AUTO RUN, COOL, HEAT and DRY operation

### Recommendations

- Use COOL in summer.
- Use HEAT in winter.
- Use DRY in spring, autumn and in damp climate.

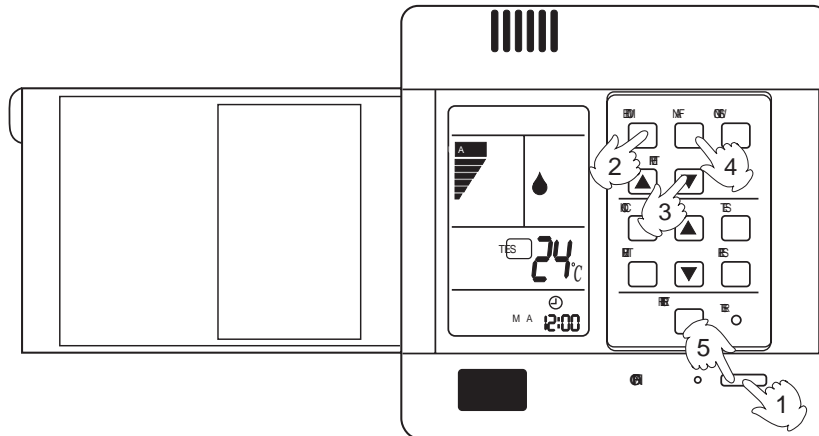

### (1) Unit start

Press ON/OFF button, unit starts.  
Previous operation status appears on display  
(Not Timer setting). Power indicator lights up.

### (2) Select operation mode

Press MODE button. For each press, operation mode changes as follows:



Unit will run in operation mode displayed on LCD.  
Stop display at your desired mode.

### (3) Select temp. setting

Press TEMP button

- ▲ Every time the button is pressed, temp. setting increases 1°C.  
If button is kept depressed, temp. setting will increase quickly.
- ▼ Every time the button is pressed, temp. setting decreases 1°C.  
If button is kept depressed, temp. setting will decrease quickly.

Unit will start running to reach the temp. setting on LCD.

### (4) Fan speed selection

Press FAN button. For each press, fan speed changes as follows:



Unit runs at the speed displayed on LCD.

In HEAT mode, warm air will blow out after a short period of time due to cold-draft prevention function.  
In DRY mode, when room temp. becomes 2°C higher than temp. setting, unit will run intermittently at LOW speed regardless of FAN setting.

### (5) Unit stop

Press ON/OFF button.  
Only time and room temp remains on LCD.  
All indicators go out.  
Vertical flap closes automatically.

### Hints

Wire controller can memorize each operation status. When starting it next time, just press ON/OFF button and unit will run in previous status.

# ■ OPERATION

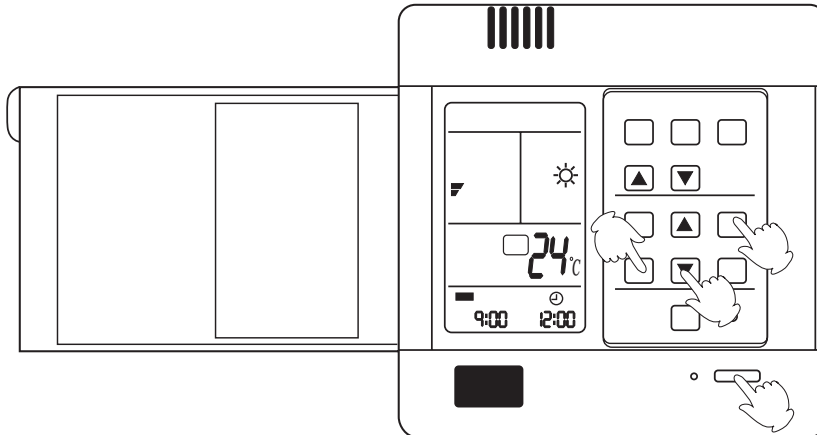

## TIMER operation

Set Clock correctly before starting Timer operation.

You can let unit start or stop automatically at following time: Before you wake up in the morning, or get back from outside or after you fall asleep at night.

## TIMER ON/OFF

(1) After unit start, select your desired operation mode.

Operation mode will be displayed on LCD.  
Power indicator lights up.

(2) TIMER mode selection

Press TIMER button to change TIMER mode.  
Every time the button is pressed, display changes as follows:



Select your desired TIMER mode (ON or OFF)

(3) Timer setting

Press TIME ▲ / ▼ button.

- ▲ Every time the button is pressed, time increases 10min.  
If button is kept depressed, time will change quickly.
- ▼ Every time the button is pressed, time decreases 10min.  
If button is kept depressed, time will change quickly.  
Time will be shown on LCD. It can be adjusted within 24hours.

(4) Confirming your setting

After setting correct time, press SET button to confirm  
"ON" or "OFF" stops flashing.

Time displayed: Unit starts or stops at x hour x min (ON or OFF).

Timer mode indicator lights up.

## To cancel TIMER mode

Just press TIMER button several times until TIMER mode disappears.

### Hints

Wire controller possesses memory function, when use TIMER mode next time, just press SET button after mode selecting if timer setting is the same as previous one.

# ■ OPERATION

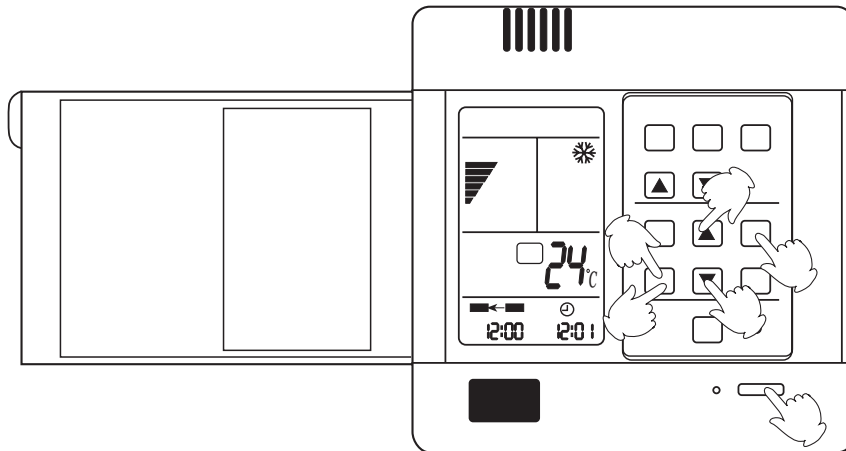

## TIMER ON-OFF

(1) After unit start, select your desired operation mode

Operation mode will be displayed on LCD.  
Power indicator lights up.

(2) Press TIMER button to change TIMER mode

Every time the button is pressed, display changes as follows:



Select  $\begin{matrix} \text{ON} \\ \text{OFF} \end{matrix}$ .

(3) Time setting for TIMER ON

Press TIME button.

- ▲ Every time the button is pressed, time increases 10min.  
If button is kept depressed, time will change quickly.
- ▼ Every time the button is pressed, time decreases 10min.  
If button is kept depressed, time will change quickly.  
Time will be shown on LCD.  
It can be adjusted within 24hours.

AM refers to morning and PM to afternoon.

(4) Time confirming for TIMER ON

After time setting, press TIMER button to confirm.  
"ON" stops blinking, While "OFF" starts blinking.  
Time displayed: Unit starts at Xhour X min.

(5) Time setting for TIMER OFF

Follow the same procedures in "Time setting for TIMER ON".

(6) Time confirming for TIMER OFF

After time setting, press SET button to confirm  
"OFF" stops flashing.  
Time displayed: Unit stops at X hour X min.

## To cancel TIMER mode

- Just press TIMER button several times until TIMER mode disappears.
- According to the Time setting sequence of TIMER ON or TIMER OFF, either Start-Stop or Stop-Start can be achieved.

# ■ OPERATION

## Comfortable Sleep

At night, before going to bed you can press down the SLEEP button on the controller and the air-conditioner will run by the comfortable sleeping mode to make you sleep more comfortable.

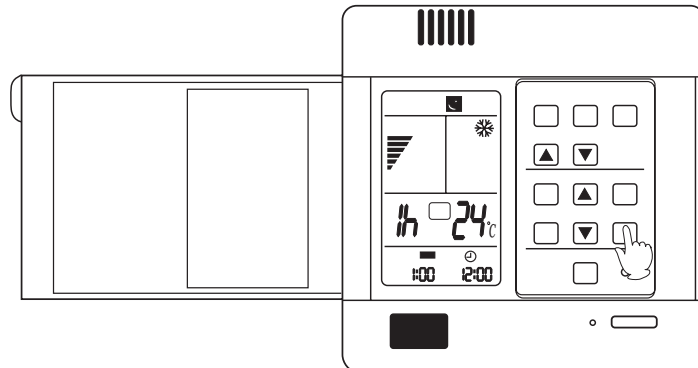

Press SLEEP button once to make the air conditioner have the previous-set sleep time (first power-on is "1h"), the sleep symbol will appear. Press time button ▲/▼, you can choose the time in 1~8 hours. Each press of ▲/▼, the time increases/reduces 1 hour and "xh" appears in the humidity setting part, "OFF" appears in "TIMER OFF" display part and timer-off time; press SLEEP button again to cancel sleep function, the sleep symbol disappears.

## In cooling, dehumidifying mode

One hour after sleeping operation start, the temp. is 1°C higher than the setting one. After another hour the temp. rises 1°C and then run continuously for another 6 hrs' and then close. The actual temp. is higher than the setting one which is to prevent from being too cool to your sleep.

## In heating mode

One hour after start up, the temp. decrease 2°C lower than the setting one. After another hour decrease by more 2°C.

The temperature will automatically rise by 1°C after another 3 hrs' operation, and then automatically close after 3 hrs' continuous operation. The actual temperature is lower than the setting one which is to prevent from being too hot to your sleep.

Note:

- In AUTO mode, unit will run in SLEEP function according to the operation mode.
- After setting SLEEP function, it is forbidden to calibrate clock.
- If the set sleep-time does not reach 8 hours, the unit will stop operation automatically after set time is complete.
- Set "TIMER-OFF" function first, then set SLEEP, and the sleep-set is performance; set TIMER-ON function first, the sleep function can only be set before TIMER-ON; if set the SLEEP function first, the TIMER function can not be set.

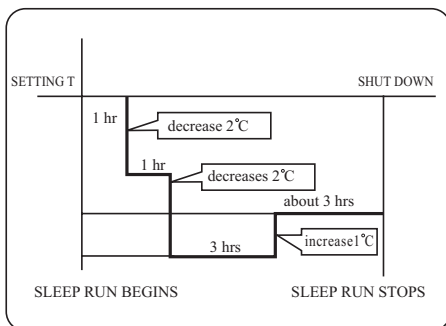

Heat mode

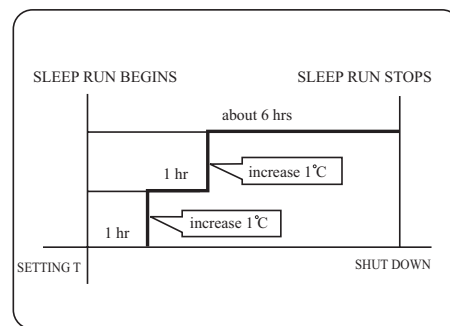

Cooling mode